



INSTALLATION

General information

The following points must be observed during installation:

- The flow direction must correspond to the marking, if present.
- The maximum torque for all flange screws must be complied with.
- Secure the flange screws and nuts against pipe vibration.
- The devices must be installed without mechanical tension (torsion, bending).
- Install flange devices / wafer-type devices with plane parallel counterflanges and use appropriate gaskets only.
- Only gaskets made from a material that is compatible with the measuring medium and measuring medium temperature may be used.
- Gaskets must not extend into the flow area, since possible turbulence could influence the accuracy of the device.
- The piping may not exert any inadmissible forces or torques on the device.
- Make sure temperature limits are not exceeded operating the device.
- Vacuum shocks in the piping should be avoided to prevent damage to the liners (PTFE). Vacuum shocks can destroy the device.
- Do not remove the sealing plugs in the cable glands until you are ready to install the electrical cable.
- Make sure the gaskets for the housing cover are seated correctly. Carefully gasket the cover. Tighten the cover fittings.
- The transmitter with a remote mount design must be installed at a largely vibration-free location.
- Do not expose the transmitter and sensor to direct sunlight. Provide appropriate sun protection as necessary.
- When installing the transmitter in a control cabinet, make sure adequate cooling is provided.

Devices with extended diagnostic functions

For devices with extended diagnostic functions different installation conditions may be valid.

NOTICE – Potential damage to device!

Improper support for the device may result in deformed housing and damage to internal magnet coils.

Place the supports at the edge of the flowmeter sensor housing

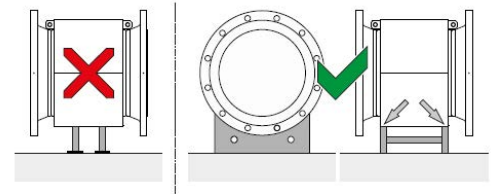

Mounting position

1. Vertical installation for measuring abrasive fluids, preferably with flow in upward direction.

2. In case of horizontal installation, the Meter tube must always be completely full.

Provide for a slight incline of the connection for degassing.

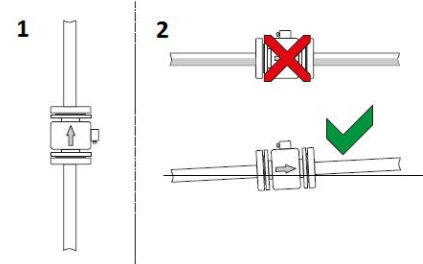

Free inlet or outlet

1. Do not install the flowmeter at the highest point or in the draining off side of the pipeline, flowmeter runs empty, air bubbles can form.

2. Provide for a siphon fluid intake for free inlets or outlets so that the pipeline is always full

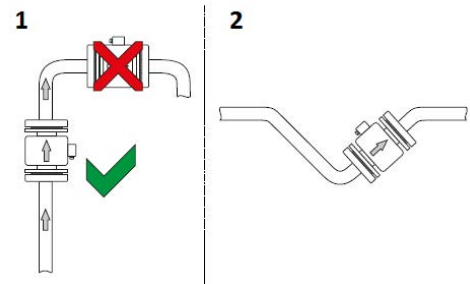

Installation in the vicinity of pumps

Pos.	Description
1	Pump
2	Damping device
3	Shut-off device

Strong vibrations in the pipeline must be damped using flexible damping devices.

The damping devices must be installed beyond the supported flowmeter section and outside of the section between the shut-off devices.

Do not connect flexible damping devices directly to the flowmeter sensor.

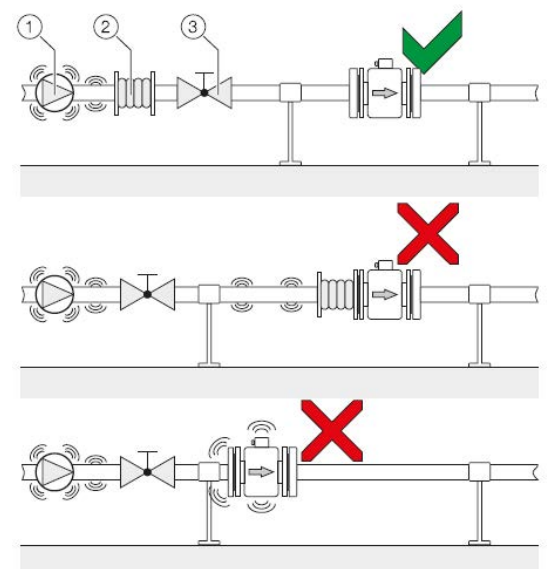



Telephone: 302 300 1919, Fax: 302 300 1619
Mail: sales@ftisensors.com www.ftisensors.com
1013 Centre Road, Suite 403S, Wilmington, DE 19805